

Our associates will ensure the tool works properly before you leave the store. If you experience issues with the tool while completing your project, simply bring it back to the Tool Rental Center to get a replacement. If you purchase Damage Protection at the time of your rental, you are not responsible for repair costs for tools that break due to normal use.

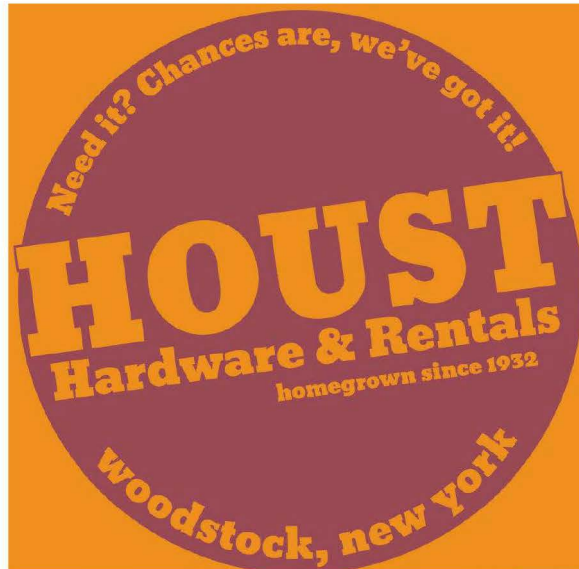



High-Pressure Extension Wands

AW-7017-1800

⚠ WARNING

⚠ **WARNING:** This product can expose you to chemicals including Lead, which is known to the State of California to cause cancer and birth defects or other reproductive harm. For more information go to www.P65Warnings.ca.gov

SPECIFICATIONS

	Fiberglass	Fiberglass	Fiberglass	Aluminum	Aluminum
Model	AW-7018-1200	AW-7018-1800	AW-7018-2400	AW-7017-1800	AW-7017-2400
Max. Volume	8 GPM	8 GPM	8 GPM	8 GPM	8 GPM
Maximum Pressure	4000 PSI	4000 PSI	4000 PSI	4000 PSI	4000 PSI
Maximum Fluid Temp.	200°F	200°F	200°F	200°F	200°F
Shipping Weight	11.8 lbs	13.4 lbs	17.6 lbs	17.3 lbs	20.7 lbs
Dimensions - Shipping	80 in. x 8 in. x 3 in.	80 in. x 8 in. x 3 in.	86 in. x 9.3 in. x 3.3 in.	86 in. x 9.3 in. x 3.7 in.	104 in. x 9 in. x 4 in.
Sections	2 - 1 Fiberglass 1 Aluminum	3 - 1 Fiberglass 2 Aluminum	4 - 2 Fiberglass 2 Aluminum	3 - Aluminum	3 - Aluminum

HAZARD	POTENTIAL CONSEQUENCE	PREVENTION
RISK OF ELECTRIC SHOCK OR ELECTROCUTION	Serious injury or death could occur from electrical shock or electrocution.	NEVER use near power lines. Keep at least 10 feet (3 meters) away from power lines. Do not touch or aim spray at electrical wiring of any kind.
RISK OF BODILY INJURY	Serious injury or death could occur.	NEVER extend or retract wand while spraying or while under pressure. Stop the equipment and relieve pressure before making any adjustments to the wand. NEVER change nozzles or accessories while under pressure. Stop the equipment and relieve pressure before making any changes. NEVER use while on ladders or scaffolding. Do not operate from ladders or elevating devices of any kind. Operator must maintain both feet on solid ground. NEVER use with unapproved accessories. NEVER exceed rated pressure or volume. NEVER use high-pressure to clean persons or animals. NEVER remove or alter warning labels or identification tags. NEVER use wand if damaged. ALWAYS read, understand, and follow operation instructions. ALWAYS make certain area is clear of obstructions or hazards. ALWAYS maintain proper balance and control of extension wand.
RISK OF EQUIPMENT DAMAGE	Risk of major repair.	Do not alter the extension wand in any manner not prescribed in this manual. Use only genuine Mi-T-M replacement parts for necessary repairs.

!SAVE THESE INSTRUCTIONS!

ASSEMBLY

FIBERGLASS EXTENSION WAND:

1. Remove the extension wand from the box and check for any shipping damage. If there is any, report it to the retailer who sold the extension wand, or to the shipping company who delivered the order.
2. Following startup instructions for your pressure washer, attach the extension wand to the high pressure hose with the quick coupler. Make sure there is a nozzle in the wand before using.
3. Grasp the extension wand firmly in both hands. Put one hand on the gun and the other on the foam grip.
4. Caution: The release of high pressure through the wand may cause the wand to kick back.
5. Gently move the wand closer to the surface you are pressure washing and wash with a side to side motion.
6. To extend the wand, lift the lever locks and slide the poles out. Do not slide the poles out of the locks. Clip the locks firmly so that the poles do not slide during use.

FIBERGLASS EXTENSION WAND		
AW-7018-1200 / AW-7018-1800 / AW-7018-2400		
ITEM #	DESCRIPTION	PART #
1	SPRAY GUN WITH LOCATING SCREWS (12'-18' FIBERGLASS)	16-0459
-	SPRAY GUN WITH LOCATING SCREWS (24' FIBERGLASS)	16-0460
2	3/8" MALE PLUG (ST-N3M)	17-0005
3	3/8" SCREW-TYPE MALE FITTING (M22) (LOOSE)	23-0493
4	1/4" HOSE ASSEMBLY (12')	15-0323
-	1/4" HOSE ASSEMBLY (18')	15-0324
-	1/4" HOSE ASSEMBLY (24')	15-0325
5	1/4" STREET BRASS ELBOW	23-0503
6	LEVER LOCK: 12' AND 18' LOWER AND 24' MIDDLE	33-0523
7	LEVER LOCK: 18' AND 24' UPPER	33-0524
8	LEVER LOCK: 24' LOWER	33-0525
9	FRONT LANCE, FOR LONG WAND (INCLUDES COUPLER & M22)	16-0462
10	3/4" X 1 1/2" SCREW TYPE FITTING MNPT (M22)	23-0505
11	AL POLE ADAPTOR FITTING, FOR WAND (18'/24' FIBERGLASS)	51-0044

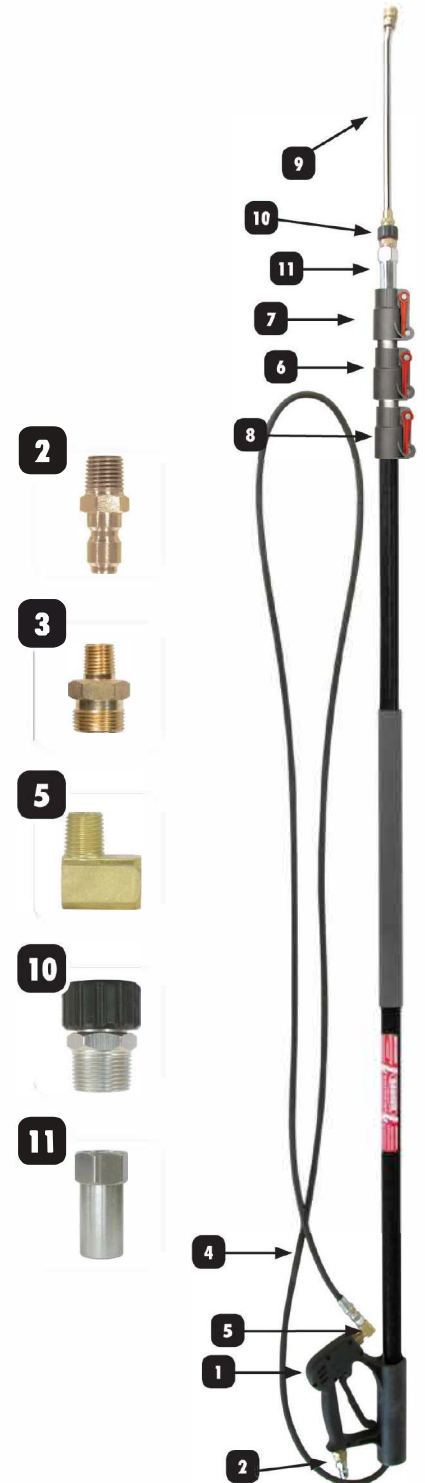

This label appears on the extension wand. Do not remove or deface. If the label becomes damaged or unreadable please call for a no charge replacement.

DANGER

ELECTRIC SHOCK HAZARD

Do not use on or near electrical wiring of any kind.
 Keep at least 10 feet (3 meters) away from power lines.
 Do not touch or aim spray at electrical wiring of any kind.
 Do not operate from ladders or elevating devices of any kind.
 Operator must maintain both feet on solid ground.

ASSEMBLY

ALUMINUM EXTENSION WAND:

1. Remove the extension wand from the box and check for any shipping damage. If there is any, report it to the retailer who sold the extension wand, or to the shipping company who delivered the order.
2. Following startup instructions for your pressure washer, attach the extension wand to the high pressure hose with the quick coupler. Make sure there is a nozzle in the wand before using.
3. Grasp the extension wand firmly in both hands. Put one hand on the gun and the other on the foam grip.
4. Caution: The release of high pressure through the wand may cause the wand to kick back.
5. Gently move the wand closer to the surface you are pressure washing and wash with a side to side motion.
6. To extend the wand, press the pin lock tabs and slide the pole out. Release tabs and allow pins to sit in the holes in the inner aluminum pole.

ALUMINUM EXTENSION WAND		
AW-7017-1800 / AW-7017-2400		
NO.	DESCRIPTION	PART#
1	SPRAY GUN C/W LOCATING SCREWS (18' - 24' ALUM)	16-0461
2	3/8" STAINLESS STEEL MALE PLUG (ST-N3M)	17-0005
3	SUPPORT BELT FOR EXTENSION WAND	AW-7015-0001
4	1/4" HOSE ASSEMBLY (18')	15-0324
	1/4" HOSE ASSEMBLY (24')	15-0325
5	1/4" 60 DEGREE BRASS ELBOW	23-0504
6	FRONT LANCE, FOR EXTENSION WAND	16-0462
7	1/4" X 1 1/2" SCREW TYPE FITTING MNPT (M22)	23-0487
8	SS HOSE ADAPTOR FITTING FOR AL WAND	24-0339
9	PIN LOCK FRONT (18'/24' ALUM)	33-0526
10	PIN LOCK BACK (18'/24' ALUM)	33-0527



This label appears on the extension wand. Do not remove or deface. If the label becomes damaged or unreadable please call for a no charge replacement.

DANGER

ELECTRIC SHOCK HAZARD

Do not use on or near electrical wiring of any kind.
 Keep at least 10 feet (3 meters) away from power lines.
 Do not touch or aim spray at electrical wiring of any kind.
 Do not operate from ladders or elevating devices of any kind.
 Operator must maintain both feet on solid ground.

OPERATION:

Read, understand, and follow ALL safety guidelines and operation instructions prior to use.

USING YOUR EXTENSION WAND:

Connect the outlet of your pressure washer to the inlet port of the trigger gun of the extension wand using appropriate quick couplers or fittings rated to handle high pressure.

NOTE: DO NOT bypass, disable, or remove the trigger gun.

The extension wand may be used fully retracted or fully extended or any point in between. Caution must be used when the wand is extended as the reaction force of the nozzle spraying will cause the wand to flex. Make absolutely certain that there are no power lines or sources of electrical power within 10 feet of the lance at any time.



WARNING: CONTACT WITH POWER TRANSMISSION LINES CAN CAUSE FATAL ELECTROCUTION!



CAUTION: DO NOT EXTEND OR RETRACT YOUR EXTENSION WAND WHILE SPRAYING OR WHILE UNDER PRESSURE.



STOP THE EQUIPMENT AND RELIEVE ANY PRESSURE BEFORE MAKING ADJUSTMENTS TO THE EXTENSION WAND OR CHANGING NOZZLES.



CAUTION: EXCEPT IN CASES OF EMERGENCY, DO NOT RELEASE THE TRIGGER NEAR ANY SURFACES.

STOP SPRAYING:

Before releasing the trigger gun move the nozzle at least ten feet away from the surface being cleaned and make sure you have solid footing. The wand will rebound when the trigger is released or if pressure is lost.

USE EXTREME CAUTION when working on or near fragile surfaces as there may be enough force to damage surfaces or break windows. Keep clear of power lines.

When you are clear of the work surface and in a safe area - release the trigger.

EXTENSION WAND OPERATING INSTRUCTIONS

When you first set up your extension wand for operation, remove each section to a maximum distance of 50% of the overall length of the section. Once you have extended the wand to 50% of its overall length, pull the trigger gun while under pressure and work with the wand to get a feel for how it performs. The further out you extend your extension wand the less accurate it becomes at the point of cleaning, and less ideal the angle at which you clean. When fully extended, each section should have approximately 6" - 8" remaining for support into the next section of pole.

Due to backwards thrusts of water under pressure, it is extremely important to pressure clean while standing firmly on solid ground and the extension wand gives you advantage to do this. Trying to get the nozzle end closer to the surface than it will normally go under full pressure can become very tiring, and can also bend the inner aluminum section of the pole if too much force is used. The wands are rated for a maximum pressure of 4000 psi and a flow of 8 GPM, with the water being carried through a single steel braided 1/4" hole.

SERVICE AND REPAIR

Your extension wand has been designed to be easily serviceable and repairable in the field. The tension of the lever locks can be adjusted by tightening or loosening the bolts. Should you have to replace the spray gun, remove the two locating screws from the rear of the gun and then unscrew the entire gun from the pole.



WARNING: BEWARE OF OVERHEAD POWER LINES. CONTACTING THESE LINES WITH THE EXTENSION WAND MAY RESULT IN ELECTROCUTION, INJURY, OR EVEN DEATH. DO NOT USE FROM LADDERS OR ELEVATING DEVICES OF ANY KIND. OPERATOR MUST MAINTAIN BOTH FEET ON SOLID GROUND.

! IMPORTANT !

ALWAYS PROVIDE A COPY OF THIS MANUAL TO ANYONE USING THIS EQUIPMENT. READ ALL INSTRUCTIONS IN THIS MANUAL AND ANY INSTRUCTIONS SUPPLIED BY MANUFACTURERS OF SUPPORTING EQUIPMENT BEFORE OPERATING THIS EQUIPMENT AND ESPECIALLY POINT OUT THE "SAFETY WARNINGS" TO PREVENT THE POSSIBILITY OF PERSONAL INJURY TO THE OPERATOR.

If you have questions, contact your Mi-T-M® Customer Service Representative at: 800-553-9053.

Mi-T-M® Corporation, 50 Mi-T-M Drive, Peosta, IA 52068-0050 USA